

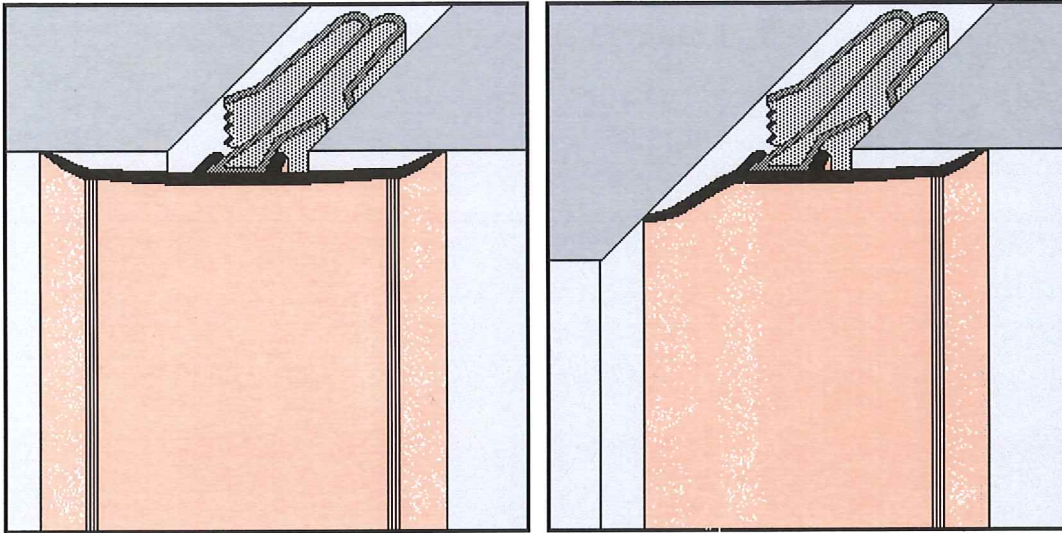

TSIRCON CO LTD

MANUFACTURERS AND TRADERS
OF BUILDING MATERIALS

SPANSTRIP ALUMINIUM JOINT PROFILE (TECHNICAL DATA)

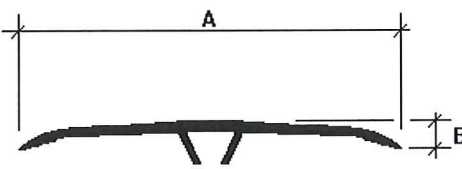
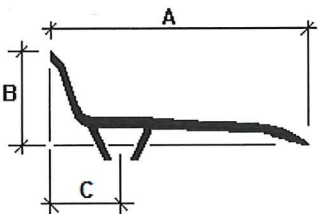
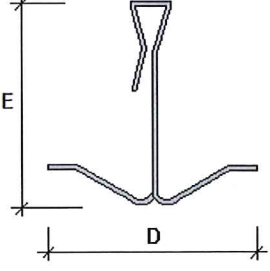

		
Modèle plat / Flat model	Modèle angle / Angle model	Clip inox / Stainless steel clip

Modèles de clips

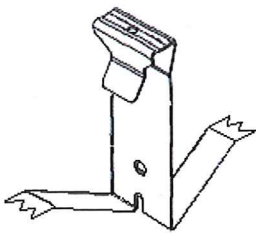

15/35

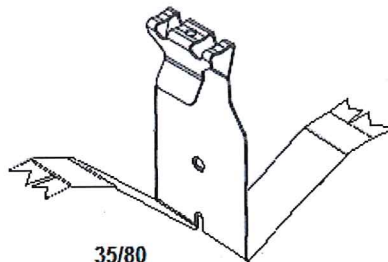

35/80

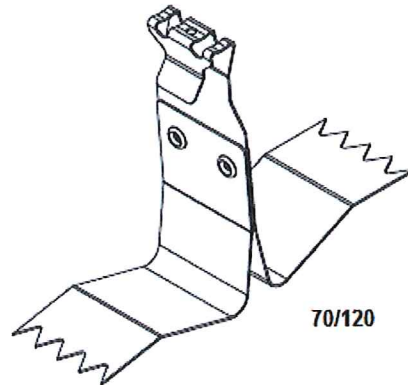

70/120



ISO 9001



Ap.QS.2.98.037

HEAD OFFICE: 7 Chalkidikis Str., Strovolos Industrial Zone, P.O.Box 23863, 1687 Nicosia, Cyprus,

BRANCH OFFICE: 4, Pythagoras Str., 3027 Limassol, Cyprus

E-mail: tsircon@tsircon.com.cy website: www.tsircon.com

Tel: 22487029, Fax: 22487716, Tel: 25358590, Fax: 25345551



<i>SPANSTRIPW..FLAT</i>	A	B		Type of clip	JOINT GAP
Spanstrip W50 Flat	50	6,5		15/35	15 – 40 mm
Spanstrip W70 Flat	70	6		15/35 or 35/80	15 – 60 mm
Spanstrip W90 Flat	90	6		35/80	35 – 80 mm
Spanstrip W120 Flat	120	6		35/80 or 70/120	35 – 100 mm
Spanstrip W140 Flat	140	6		35/80 or 70/120	35 – 120 mm
<i>SPANSTRIPW...ANGLE</i>	A	B	C	Type of clip	JOINT GAP
Spanstrip W50 Angle	50	20	15	15/35	20 - 40 mm
Spanstrip W70 Angle	70	25	20	15/35 or 35/80	30 -60 mm
Spanstrip W 90 Angle	90	32	30	35/80	40 -80 mm
Spanstrip W 120 Angle	120	32	35	35/80 or 70/120	50 - 100mm
Spanstrip W 140 Angle	140	37	50	35/80 or 70/120	60 - 120 mm

Clips for fixation	Dimensions D x E	Joint gap
Clips 15/35	50 x 40	15 - 40 mm
Clips 35/80	90 x 60	35 - 80 mm
Clips 70/120	125 x 90	70 – 120mm

Sections	Flat and internal corner
Materials	Mill-finish Aluminium alloy AGST5
Chemical resistance	Impervious to industrial fumes and sea air
Standard length	3 meters-special lengths in quantity on request
Fixing clips	Stainless spring steel for joints of 10 to 40 mm and 40 to 50 Joint size must be specified when ordering.

For Horizontal Joints	
Number of clips supplied per 3 metre length	10
Recommended spaces between clips	0.30 m.

For Vertical Joints		
Number of clips supplied per 3 metre length	4	
Number of clips recommended for inaccessible joints	Up to 0.90 m.	2
	0.90 to 1.50 m.	3
	1.50 to 2.00 m.	3
	2.00 to 3.00 m.	4
	3.00 m upwards	1 every 0.85 m